

# Course image

You can add a thematically appropriate course image to your course. Files of the format PNG/JPG/GIF are allowed. Optimally, choose the dimension **413x112px** for the graphic.

## Instructions:

1. Turn on editing
2. Select Edit Settings
3. in the tab "description" scroll to the item "course image"
4. in the file selection window select **Add file**

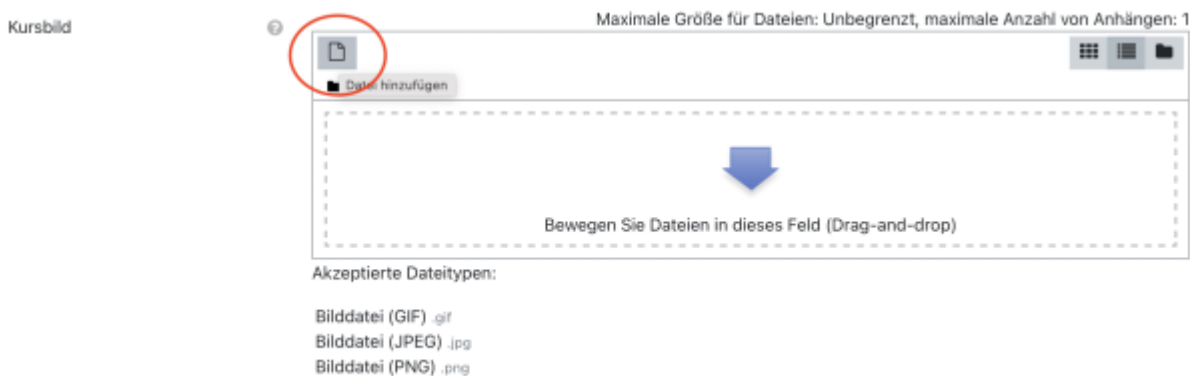

5. Select desired image file from your explorer/finder.

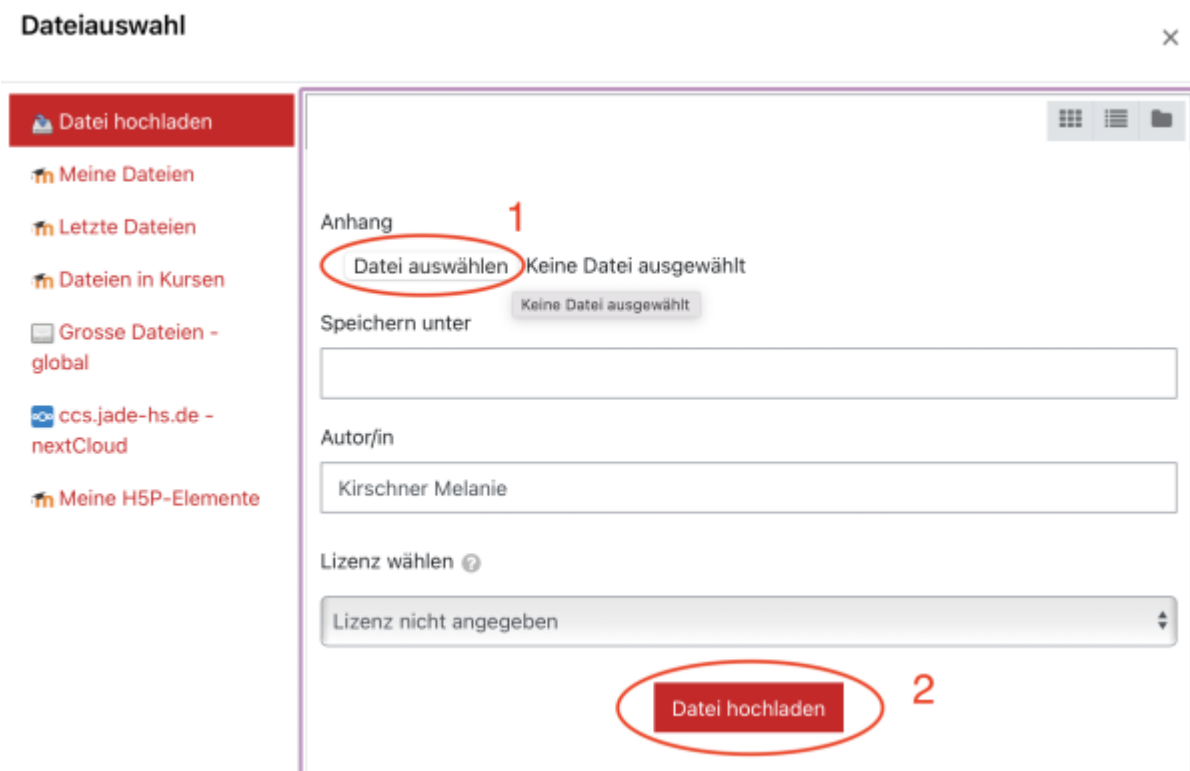

6. Save course settings.

You want to delete the course image again? Simply select the image in the file selector and click on

the trash button.

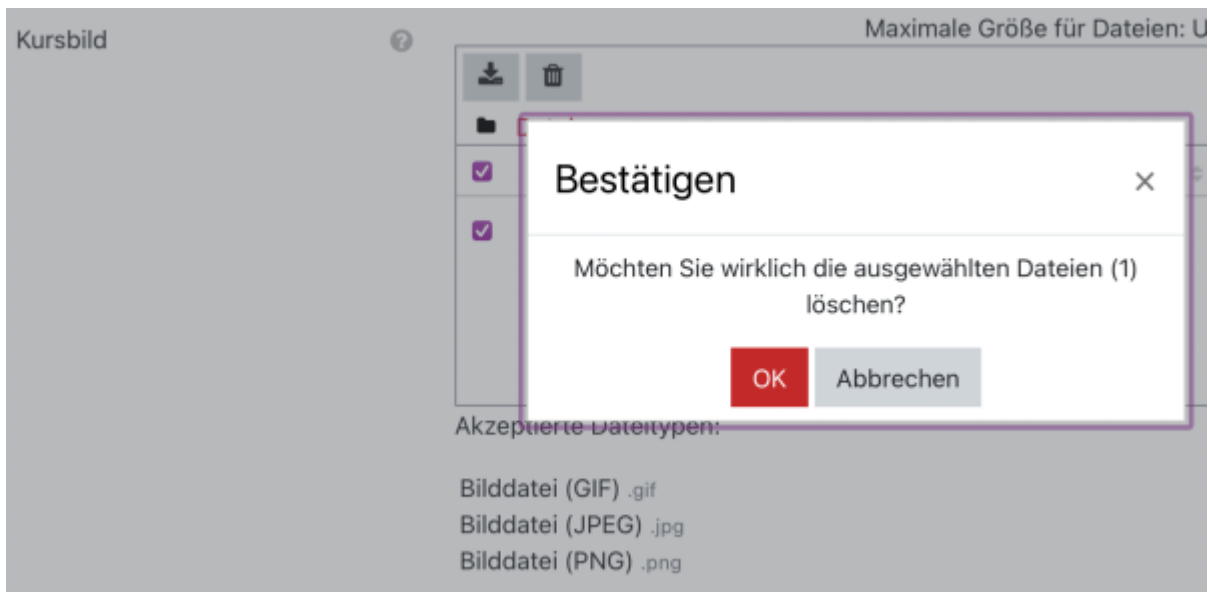

From:  
<https://lms-wiki.jade-hs.de/> - **LMS-Wiki**

Permanent link:  
<https://lms-wiki.jade-hs.de/en/moodle/course/settings/image/start?rev=1698137336>

Last update: **2023/10/24 10:48**

