

Registration

Members of Jade UAS

Members use their credentials at Jade University of Applied Sciences.

- „Log in using your account on: Jade Hochschule“ (2)

Other users

For participation in courses you will need to create an account with a username, keyword, your first name, surname and valid mail address. („[Selfregistration](#)“)

Voluntary consent

For self-registration you consent in the onetime usage of the service reCAPTCHA of Google. Otherwise [contact](#) us. On registration, please consent to our legal framework by checking both privacy policy and terms of use (under-age persons will ask their parents). Unconfirmed accounts will be deleted within seven days.

- Create account: [Selfregistration](#)

Login options

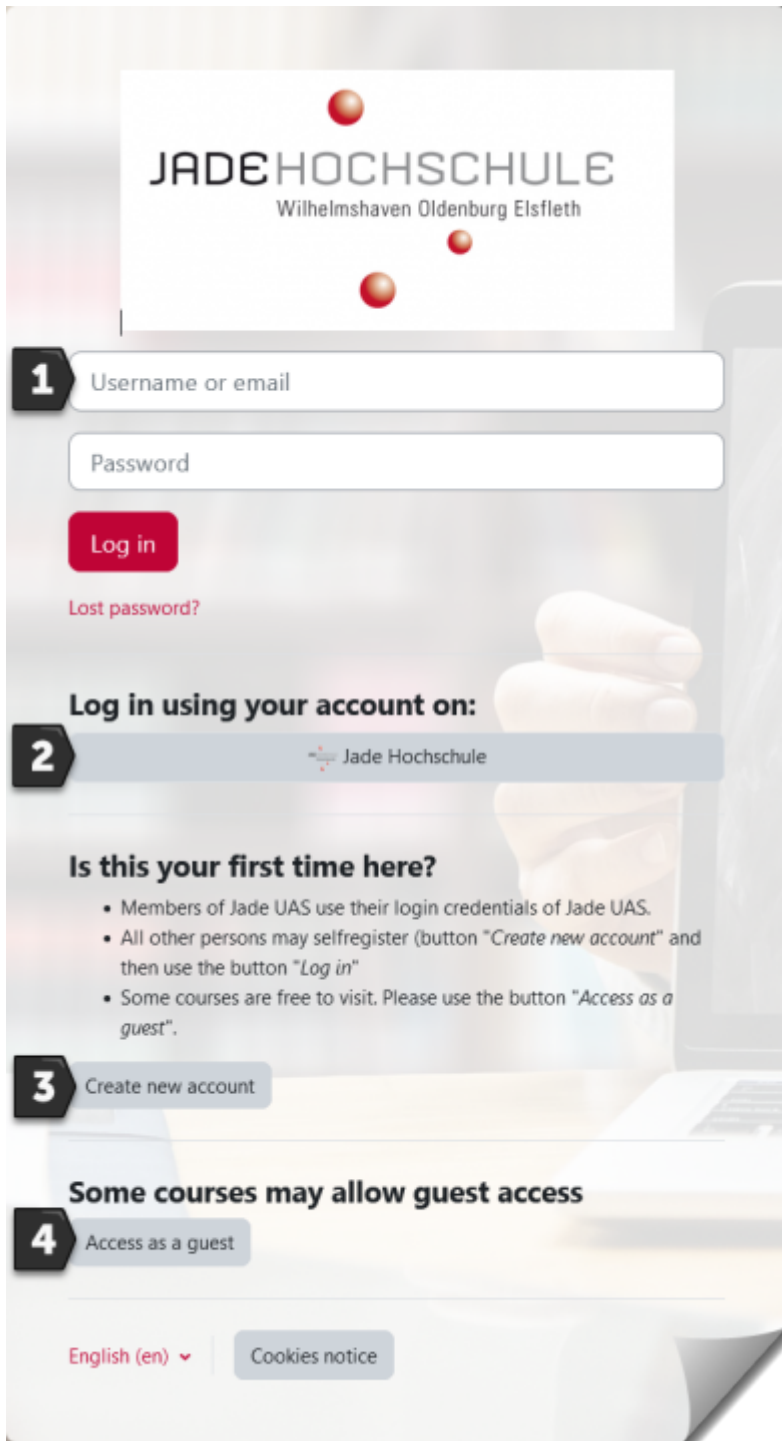

Selfregistration

- Button „Create a new account“ (3)
- Login on top of page (1)

Confirm registration

To confirm registration, you will receive a mail attended to your registration mail. Please check your spam-folder.

02.10.2023 10:48:57 Moodlesupport Jade Hochschule (via Offene JHS) <noreply@jade-hs.de>:

Hi,

A new account has been requested at 'Offene Jade Hochschule' using your email address.

To confirm your new account, please go to this web address:

<https://offene.jade-hs.de/moodle/login/confirm.php?data=99CYPw6y1J...>

In most mail programs, this should appear as a blue link which you can just click on. If that doesn't work, then cut and paste the address into the address line at the top of your web browser window.

If you need help, please contact the site administrator,

Moodlesupport Jade Hochschule
[Contact site support](#)

Figure: Mail sent by „noreply@jade-hs.de“

Guest access

Some courses are accessible for guests. „Guest access“ needs no registration but has limited access (e.g. no upload for files)

- Guests hit the button „Access as a guest“ (4)

From:
<https://lms-wiki.jade-hs.de/> - **LMS-Wiki**

Permanent link:
<https://lms-wiki.jade-hs.de/en/moodle/offene/signup/start?rev=1749630230>

Last update: **2025/06/11 10:23**

